

SYSTEM
PLAST

Conveying Chain

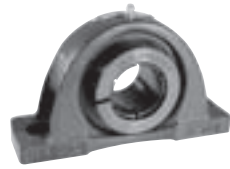

SEALMASTER

Mounted Ball Bearings



MORSE

Clutches



Browning

Shaft Mount Reducers



SEALMASTER

Mounted Roller Bearings



ROLLWAY

Ball Bearings



Browning

V-Belt Drives



MORSE

Chain



KOP-FLEX

Couplings



JAURE

Wind Couplings



ROLLWAY

Roller Bearings



MCGILL

Precision Bearings

ROLLWAY®

Rollway Bearing nv

Heiveldekens 16

2550 Kontich, Belgium

Tel +32(0)3 457 68 70

Fax +32(0)3 457 51 38

E-mail info@rollway-bearing.be

www.emerson-ept.com



EMERSON™ Industrial Automation

APPLICATION CONSIDERATIONS

The proper selection and application of power transmission products and components, including the related area of product safety, is the responsibility of the customer. Operating and performance requirements and potential associated issues will vary appreciably depending upon the use and application of such products and components. The scope of the technical and application information included in this publication is necessarily limited. Unusual operating environments and conditions, lubrication requirements, loading supports, and other factors can materially affect the application and operating results of the products and components and the customer should carefully review its requirements. Any technical advice or review furnished by Emerson Power Transmission Corporation and its divisions with respect to the use of products and components is given in good faith and without charge, and Emerson assumes no obligation or liability for the advice given, or results obtained, all such advice and review being given and accepted at customer's risk.

For a copy of our Standard Terms and Conditions of Sale, Disclaimers of Warranty, Limitation of Liability and Remedy, please contact Emerson Power Transmission Customer Service at 1-800-626-2120. These terms and conditions of sale, disclaimers and limitations of liability apply to any person who may buy, acquire or use an Emerson Power Transmission Corporation product referred to herein, including any person who buys from a licensed distributor of these branded products.

Emerson Power Transmission does not warrant the accuracy of the information contained in this document. All interchanges should be compared with actual current specifications and/or manufacturing drawings. For a copy of our standard terms and conditions, contact Emerson Power Transmission at 1-800-626-2120.

Emerson, Emerson. Consider It Solved. Emerson Industrial Automation and Rollway are trademarks of Emerson Electric Co. or one of its affiliated companies.
©2011 Emerson Power Transmission Corp., All Rights Reserved. MCB11024E- Form 9496E- Printed in Belgium



ROLLWAY®

GMEX • Excellence line



Spherical Roller Bearings



EMERSON™ Industrial Automation

EMERSON. CONSIDER IT SOLVED.™

ROLLWAY

Spherical Roller Bearings GMEX - Excellence line



“Customers all across the globe challenge us in finding solutions that optimize their production and reduce their energy consumption. They expect high quality for a competitive price. Well, they are right and GMEX is what they are looking for.”

Gerrit Moeyersons, Quality Director - Rollway Bearing NV

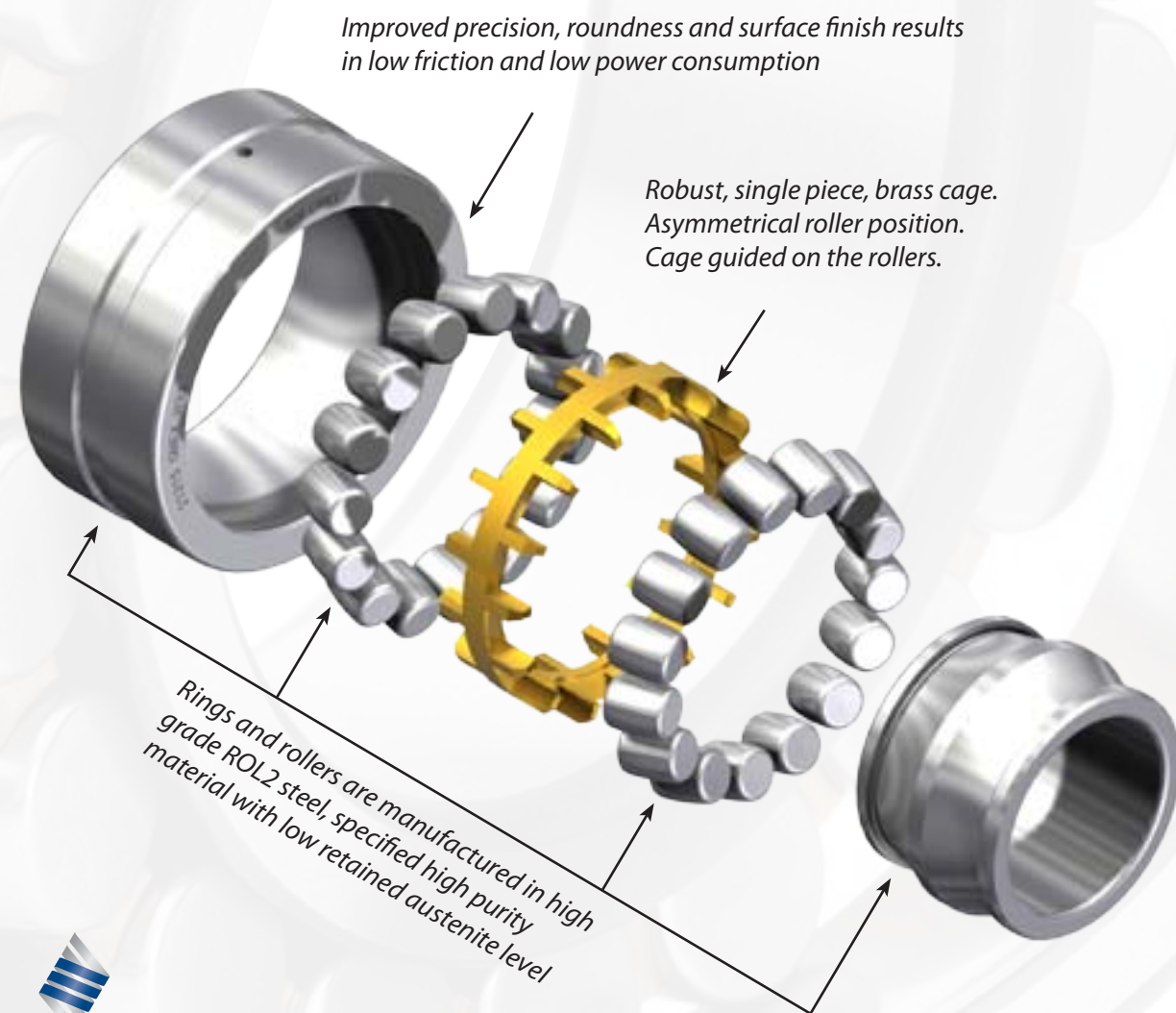

EXCELLENT PERFORMANCE FOR

- Industrial heavy duty equipment
- Gearboxes
- Rolling Machines
- Various applications where spherical roller bearings can be engaged

SERIES

- 22205 to 22220
- 22308 to 22316
- 21306 to 21320

YOUR BENEFITS

- Excellent load ratings
- Long service life
- Smooth running
- Low noise and vibrations
- Low maintenance cost

WHY GMEX?

- **G**enuine Rollway is the smartest choice
- **M**achined brass cage
- **EX**cellence line



About Rollway

History: since 1908, when Rollway was founded, our customers value our quality.

Design and Quality: all designs have been approved according to the strict Emerson guidelines and the Rollway Quality Department standards.

Support: the highly professional customer service teams provide world class services with a fast and personalized support in more than 10 languages

Lead time: global availability and short lead times are ensured with a master distribution centre in Belgium and hubs in China and the USA

EMERSON
Industrial Automation

